

## Flush Ring Pull

### FRP50 Range

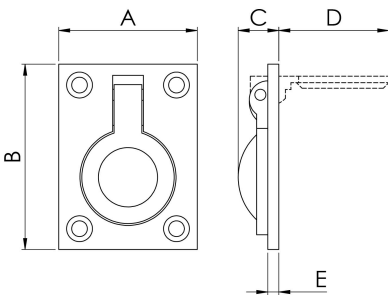

Flush ring pull handle is used for pulling flush panels, sliding doors, trap doors, cabinet doors, traditional kitchen drawers and any situation where a handle with a projection would not be suitable. Basic and easy to operate, simply pull on the ring which will elevate and in turn pull the item to which the mounting plate is affixed. Larger version available for heavier applications. Comes with a 10 year mechanical guarantee.

